

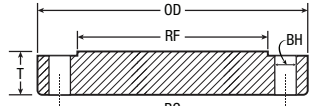

ANSI B16.5 & B16.47 BLIND FLANGE SPECIFICATIONS

Call for more info. (800) 456-8721 • USAIndustries.com

S. Houston, TX | Corpus Christie, TX | Prairieville, LA | Broken Arrow, OK



NPS	OD OF FLANGE (OD)	DIA. OF BOLT CIRCLE (BC)	DIA. OF RAISED FACE (RF)	NO. OF BOLT HOLES	DIA. OF BOLT HOLE (BH)	BLIND THK. (T)	300 ANSI B16.5						600 ANSI B16.5						900 ANSI B16.5						1500 ANSI B16.5						2500 ANSI B16.5						
							OD OF FLANGE (OD)	DIA. OF BOLT CIRCLE (BC)	DIA. OF RAISED FACE (RF)	NO. OF BOLT HOLES	DIA. OF BOLT HOLE (BH)	BLIND THK. (T)	OD OF FLANGE (OD)	DIA. OF BOLT CIRCLE (BC)	DIA. OF RAISED FACE (RF)	NO. OF BOLT HOLES	DIA. OF BOLT HOLE (BH)	BLIND THK. (T)	OD OF FLANGE (OD)	DIA. OF BOLT CIRCLE (BC)	DIA. OF RAISED FACE (RF)	NO. OF BOLT HOLES	DIA. OF BOLT HOLE (BH)	BLIND THK. (T)	OD OF FLANGE (OD)	DIA. OF BOLT CIRCLE (BC)	DIA. OF RAISED FACE (RF)	NO. OF BOLT HOLES	DIA. OF BOLT HOLE (BH)	BLIND THK. (T)	OD OF FLANGE (OD)	DIA. OF BOLT CIRCLE (BC)	DIA. OF RAISED FACE (RF)	NO. OF BOLT HOLES	DIA. OF BOLT HOLE (BH)	BLIND THK. (T)	
1/2	3.50	2.38	1.38	4	0.62	0.44	3.75	2.62	1.38	4	0.63	0.56	3.75	2.62	1.38	4	0.63	0.56	4.75	3.25	1.38	4	0.88	0.88	4.75	3.25	1.38	4	0.88	0.88	5.25	3.50	1.38	4	0.88	1.19	
3/4	3.88	2.75	1.69	4	0.62	0.50	4.62	3.25	1.69	4	0.75	0.62	4.62	3.25	1.69	4	0.75	0.62	5.12	3.50	1.69	4	0.88	1.00	5.12	3.50	1.69	4	0.88	1.00	5.50	3.75	1.69	4	0.88	1.25	
1	4.25	3.12	2.00	4	0.62	0.56	4.88	3.50	2.00	4	0.75	0.69	4.88	3.50	2.00	4	0.75	0.69	5.88	4.00	2.00	4	1.00	1.12	5.88	4.00	2.00	4	1.00	1.12	6.25	4.25	2.00	4	1.00	1.38	
1-1/4	4.62	3.50	2.50	4	0.62	0.62	5.25	3.88	2.50	4	0.75	0.75	5.25	3.88	2.50	4	0.75	0.75	6.25	4.38	2.50	4	1.00	1.12	6.25	4.38	2.50	4	1.00	1.12	7.25	5.13	2.50	4	1.12	1.50	
1-1/2	5.00	3.88	2.88	4	0.62	0.69	6.12	4.50	2.88	4	0.88	0.81	6.12	4.50	2.88	4	0.88	0.88	7.00	4.88	2.88	4	1.12	1.25	7.00	4.88	2.88	4	1.12	1.25	8.00	5.75	2.88	4	1.25	1.75	
2	6.00	4.75	3.63	4	0.75	0.75	6.50	5.00	3.62	8	0.75	0.88	6.50	5.00	3.62	8	0.75	1.00	8.50	6.50	3.63	8	1.00	1.50	8.50	6.50	3.63	8	1.00	1.50	9.25	6.75	3.63	8	1.12	2.00	
2-1/2	7.00	5.50	4.13	4	0.75	0.88	7.50	5.88	4.12	8	0.88	1.00	7.50	5.88	4.12	8	0.88	1.12	9.62	7.50	4.13	8	1.13	1.62	9.62	7.50	4.13	8	1.12	1.62	10.50	7.75	4.13	8	1.25	2.25	
3	7.50	6.00	5.00	4	0.75	0.94	8.25	6.62	5.00	8	0.88	1.12	8.25	6.62	5.00	8	0.88	1.25	9.50	7.50	5.00	8	1.00	1.50	10.50	8.00	5.00	8	1.25	1.88	12.00	9.00	5.00	8	1.38	2.62	
3-1/2	8.50	7.00	5.50	8	0.75	0.94	9.00	7.25	5.50	8	0.88	1.19	9.00	7.25	5.50	8	1.00	1.38	—	—	—	—	—	—	—	—	—	—	—	—	—	—	—	—	—	—	—
4	9.00	7.50	6.19	8	0.75	0.94	10.00	7.88	6.19	8	0.88	1.25	10.00	7.88	6.19	8	1.00	1.50	11.50	9.25	6.19	8	1.25	1.75	12.25	9.50	6.19	8	1.38	2.12	14.00	10.75	6.19	8	1.63	3.00	
5	10.00	8.50	7.31	8	0.88	0.94	11.00	9.25	7.31	8	0.88	1.38	13.00	10.50	7.31	8	1.12	1.75	13.75	11.00	7.31	8	1.38	2.00	14.75	11.50	7.31	8	1.63	2.88	16.50	12.75	7.31	8	1.88	3.62	
6	11.00	9.50	8.50	8	0.88	1.00	12.50	10.62	8.50	12	0.88	1.44	14.00	11.50	8.50	12	1.12	1.88	15.00	12.50	8.50	12	1.25	2.19	15.50	12.50	8.50	12	1.50	3.25	19.00	14.50	8.50	8	2.12	4.25	
8	13.50	11.75	10.63	8	0.88	1.12	15.00	13.00	10.62	12	1.00	1.62	16.50	13.75	10.62	12	1.25	2.19	18.50	15.50	10.63	12	1.50	2.50	19.00	15.50	10.63	12	1.75	3.62	21.75	17.25	10.63	12	2.12	5.00	
10	16.00	14.25	12.75	12	1.00	1.19	17.50	15.25	12.75	16	1.12	1.88	20.00	17.00	12.75	16	1.38	2.50	21.50	18.50	12.75	16	1.50	2.75	23.00	19.00	12.75	12	2.00	4.25	26.50	21.25	12.75	12	2.63	6.50	
12	19.00	17.00	15.00	12	1.00	1.25	20.50	17.75	15.00	16	1.25	2.00	22.00	19.25	15.00	20	1.38	2.62	24.00	21.00	15.00	20	1.50	3.12	26.50	22.50	15.00	16	2.12	4.88	30.00	24.38	15.00	12	2.88	7.25	
14	21.00	18.75	16.25	12	1.12	1.38	23.00	20.25	16.25	20	1.25	2.12	23.75	20.75	16.25	20	1.50	2.75	25.25	22.00	16.25	20	1.63	3.38	29.50	25.00	16.25	16	2.38	5.25	—	—	—	—	—	—	
16	23.50	21.25	18.50	16	1.12	1.44	25.50	22.50	18.50	20	1.38	2.25	27.00	23.75	18.50	20	1.63	3.00	27.75	24.25	18.50	20	1.75	3.50	32.50	27.75	18.50	16	2.63	5.75	—	—	—	—	—	—	
18	25.00	22.75	21.00	16	1.25	1.56	28.00	24.75	21.00	24	1.38	2.38	29.25	25.75	21.00	20	1.75	3.25	31.00	27.00	21.00	20	2.00	4.00	36.00	30.50	21.00	16	2.88	6.38	—	—	—	—	—	—	
20	27.50	25.00	23.00	20	1.25	1.69	30.50	27.00	23.00	24	1.38	2.50	32.00	28.50	23.00	24	1.75	3.50	33.75	29.50	23.00	20	2.13	4.25	38.75	32.75	23.00	16	3.12	7.00	—	—	—	—	—	—	
22	29.50	27.25	25.25	20	1.38	1.81	33.00	29.25	25.25	24	1.63	2.63	34.25	30.63	25.25	24	1.75	3.75	—	—	—	—	—	—	—	—	—	—	—	—	—	—	—	—	—	—	
24	32.00	29.50	27.25	20	1.38	1.88	36.00	32.00	27.25	24	1.63	2.75	37.00	33.00	27.25	24	2.00	4.00	41.00	35.50	27.25	20	2.63	5.50	46.00	39.00	27.25	16	3.63	8.00	—	—	—	—	—	—	

ANSI 16.47 - SERIES A																									
NPS	OD OF FLANGE (OD)	DIA. OF BOLT CIRCLE (BC)	DIA. OF RAISED FACE (RF)	NO. OF BOLT HOLES	DIA. OF BOLT HOLE (BH)	BLIND THK. (T)	300 ANSI B16.5						600 ANSI B16.5						900 ANSI B16.5						
							OD OF FLANGE (OD)	DIA. OF BOLT CIRCLE (BC)	DIA. OF RAISED FACE (RF)	NO. OF BOLT HOLES	DIA. OF BOLT HOLE (BH)	BLIND THK. (T)	OD OF FLANGE (OD)	DIA. OF BOLT CIRCLE (BC)	DIA. OF RAISED FACE (RF)	NO. OF BOLT HOLES	DIA. OF BOLT HOLE (BH)	BLIND THK. (T)	OD OF FLANGE (OD)	DIA. OF BOLT CIRCLE (BC)	DIA. OF RAISED FACE (RF)	NO. OF BOLT HOLES	DIA. OF BOLT HOLE (BH)	BLIND THK. (T)	
26	34.25	31.75	29.50	24	1.38	2.63	38.25	34.50	29.50	28	1.75	3.25	40.00	36.00	29.50	28	2.00	4.94	42.75	37.50	29.50	20	2.88	6.31	
28	36.50	34.00	31.50	28	1.38	2.75	40.75	37.00	31.50	28	1.75	3.50	42.25	38.00	31.50	28	2.12	5.19	46.00	40.25	31.50	20	3.12	6.75	
30	38.75	36.00	33.75	28	1.38	2.88	43.00	39.25	33.75	28	1.88	3.69	44.50	40.25	33.75	28	2.12	5.50	48.50	42.75	33.75	20	3.12	7.18	
32	41.75	38.50	36.00	28	1.62	3.13	45.25	41.50	36.00	28	2.00	3.88	47.00	42.50	36.00	28	2.38	5.81	51.75	45.50	36.00	20	3.38	7.62	
34	43.75	40.50	38.00	32	1.62	3.19	47.50	43.50	38.00	28	2.00	4.07	49.00	44.50	38.00	28	2.38	6.06	55.00	48.25	38.00	20	3.62	8.06	
36	46.00	42.75	40.25	32	1.62	3.50	50.00	46.00	40.25	32	2.12	4.32	51.75	47.00	40.25	28	2.62	6.38	57.50	50.75	40.25	20	3.62	8.44	
38	48.75	45.25	42.25	32	1.62	3.38	46.00	43.00	40.50	32	1.62	4.19	50.00	45.75	41.50	28	2.38	6.12	57.50	50.75	43.25	20	3.62	8.50	
40	50.75	47.25	44.25	36	1.62	3.50	48.75	45.50	42.75	32	1.75	4.44	52.00	47.75	43.75	32	2.38	6.38	59.50	52.75	45.75	24	3.62	8.81	
42	53.00	49.50	47.00	36	1.62	3.75	50.75	47.50	44.75	32	1.75	4.63	55.25	50.50	46.00	28	2.62	6.75	61.50	54.75	47.75	24	3.62	9.12	
44	55.25	51.75	49.00	40	1.62	3.94	53.25	49.75	47.00	32	1.88	4.82	57.25	52.50	48.25	32	2.62	7.00	64.88	57.62	50.00	24	3.88	9.56	
46	57.25	53.75	51.00	40	1.62	4.00	55.75	52.00	49.00	28	2.00	5.00	59.50	54.75	50.25	32	2.62	7.31	68.25	60.50	52.50	24	4.12	10.06	
48	59.50	56.00	53.50	44	1.62	4.19	57.75	54.00	51.25	32	2.00	5.19	62.75	57.50	52.50	32	2.62	7.69	70.25	62.50	54.50	24	4.12	10.38	
50	61.75	58.25	55.50	44	1.88	4.32	60.25	56.25	53.50	32	2.12	5.44	65.75	60.00	54.50	28	3.12	8.00	—	—	—	—	—	—	
52	64.00	60.50	57.50	44	1.88	4.50	62.25	58.25	—	32	2.12	5.63	67.75	62.00	—	32	3.12	8.25	—	—	—	—	—	—	
54	66.25	62.75	59.50	44	1.88	4.69	65.25	61.00	—	28	2.38	5.94	70.00	64.25	—	32	3.12	8.56	—	—	—	—	—	—	
56	68.75	65.00	62.00	48	1.88	4.82	67.25	63.00	—	28	2.38	6.00	73.00	66.75	—	32	3.38	8.88	—	—	—	—	—	—	
58	71.00	67.25	64.00	48	1.88	5.00	69.25	65.00	—	32	2.38	6.19	75.00	68.75	—	32	3.38	9.12	—	—	—	—	—	—	
60	73.00	69.25	66.00	52	1.88	5.13	71.25	67.00	—	32	2.38	6.38	78.50	71.75	—	28	3.62	9.56	—	—	—	—	—	—	

ANSI 16.47 - SERIES B																									
NPS	OD OF FLANGE (OD)	DIA. OF BOLT CIRCLE (BC)	DIA. OF RAISED FACE (RF)	NO. OF BOLT HOLES	DIA. OF BOLT HOLE																				