

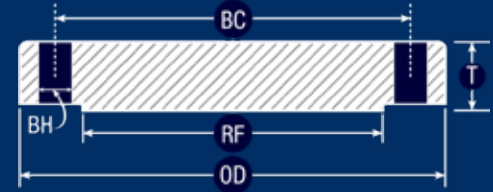

ANSI B16.5 & B16.47 BLIND FLANGE SPECIFICATIONS

Call for more info. (800) 456-8721 • (713) 941-3797 • www.USAIndustries.com



NPS	CLASS 150 ANSI B16.5						300 ANSI B16.5						600 ANSI B16.5						900 ANSI B16.5						1500 ANSI B16.5						2500 ANSI B16.5						
	OD OF FLANGE (OD)	DIA. OF BOLT CIRCLE (BC)	DIA. OF RAISED FACE (RF)	NO. OF BOLT HOLES	DIA. OF BOLT HOLE (BH)	BLIND THICKNESS (T)	OD OF FLANGE (OD)	DIA. OF BOLT CIRCLE (BC)	DIA. OF RAISED FACE (RF)	NO. OF BOLT HOLES	DIA. OF BOLT HOLE (BH)	BLIND THICKNESS (T)	OD OF FLANGE (OD)	DIA. OF BOLT CIRCLE (BC)	DIA. OF RAISED FACE (RF)	NO. OF BOLT HOLES	DIA. OF BOLT HOLE (BH)	BLIND THICKNESS (T)	OD OF FLANGE (OD)	DIA. OF BOLT CIRCLE (BC)	DIA. OF RAISED FACE (RF)	NO. OF BOLT HOLES	DIA. OF BOLT HOLE (BH)	BLIND THICKNESS (T)	OD OF FLANGE (OD)	DIA. OF BOLT CIRCLE (BC)	DIA. OF RAISED FACE (RF)	NO. OF BOLT HOLES	DIA. OF BOLT HOLE (BH)	BLIND THICKNESS (T)	OD OF FLANGE (OD)	DIA. OF BOLT CIRCLE (BC)	DIA. OF RAISED FACE (RF)	NO. OF BOLT HOLES	DIA. OF BOLT HOLE (BH)	BLIND THICKNESS (T)	
1/2	3.50	2.38	1.38	4	0.62	0.44	3.75	2.62	1.38	4	0.63	0.56	3.75	2.62	1.38	4	0.63	0.56	4.75	3.25	1.38	4	0.88	0.88	4.75	3.25	1.38	4	0.88	0.88	5.25	3.50	1.38	4	0.88	1.19	
3/4	3.88	2.75	1.69	4	0.62	0.50	4.62	3.25	1.69	4	0.75	0.62	4.62	3.25	1.69	4	0.75	0.62	5.12	3.50	1.69	4	0.88	1.00	5.12	3.50	1.69	4	0.88	1.00	5.50	3.75	1.69	4	0.88	1.25	
1	4.25	3.12	2.00	4	0.62	0.56	4.88	3.50	2.00	4	0.75	0.69	4.88	3.50	2.00	4	0.75	0.69	5.88	4.00	2.00	4	1.00	1.12	5.88	4.00	2.00	4	1.00	1.12	6.25	4.25	2.00	4	1.00	1.38	
1-1/4	4.62	3.50	2.50	4	0.62	0.62	5.25	3.88	2.50	4	0.75	0.75	5.25	3.88	2.50	4	0.75	0.81	6.25	4.38	2.50	4	1.00	1.12	6.25	4.38	2.50	4	1.00	1.12	7.25	5.13	2.50	4	1.12	1.50	
1-1/2	5.00	3.88	2.88	4	0.62	0.69	6.12	4.50	2.88	4	0.88	0.81	6.12	4.50	2.88	4	0.88	0.88	7.00	4.88	2.88	4	1.12	1.25	7.00	4.88	2.88	4	1.12	1.25	8.00	5.75	2.88	4	1.25	1.75	
2	6.00	4.75	3.63	4	0.75	0.75	6.50	5.00	3.62	8	0.75	0.88	6.50	5.00	3.62	8	0.75	1.00	8.50	6.50	3.63	8	1.00	1.25	8.50	6.50	3.63	8	1.00	1.50	9.25	6.75	3.63	8	1.12	2.00	
2-1/2	7.00	5.50	4.13	4	0.75	0.88	7.50	5.88	4.12	8	0.88	1.00	7.50	5.88	4.12	8	0.88	1.12	9.62	7.50	4.13	8	1.13	1.62	9.62	7.50	4.13	8	1.12	1.62	10.50	7.75	4.13	8	1.25	2.25	
3	7.50	6.00	5.00	4	0.75	0.94	8.25	6.62	5.00	8	0.88	1.12	8.25	6.62	5.00	8	0.88	1.25	9.50	7.50	5.00	8	1.00	1.50	10.50	8.00	5.00	8	1.25	1.88	12.00	9.00	5.00	8	1.38	2.62	
3-1/2	8.50	7.00	5.50	8	0.75	0.94	9.00	7.25	5.50	8	0.88	1.19	9.00	7.25	5.50	8	1.00	1.38	-	-	-	-	-	-	-	-	-	-	-	-	-	-	-	-	-	-	-
4	9.00	7.50	6.19	8	0.75	0.94	10.00	7.88	6.19	8	0.88	1.25	10.75	8.50	6.19	8	1.00	1.50	11.50	9.25	6.19	8	1.25	1.75	12.25	9.50	6.19	8	1.38	2.12	14.00	10.75	6.19	8	1.63	3.00	
5	10.00	8.50	7.31	8	0.88	0.94	11.00	9.25	7.31	8	0.88	1.38	13.00	10.50	7.31	8	1.12	1.75	13.75	11.00	7.31	8	1.38	2.00	14.75	11.50	7.31	8	1.63	2.88	16.50	12.75	7.31	8	1.88	3.62	
6	11.00	9.50	8.50	8	0.88	1.00	12.50	10.62	8.50	12	0.88	1.44	14.00	11.50	8.50	12	1.12	1.88	15.00	12.50	8.50	12	1.25	2.19	15.50	12.50	8.50	12	1.50	3.25	19.00	14.50	8.50	8	2.12	4.25	
8	13.50	11.75	10.63	8	0.88	1.12	15.00	13.00	10.62	12	1.00	1.62	16.50	13.75	10.62	12	1.25	2.19	18.50	15.50	10.63	12	1.50	2.50	19.00	15.50	10.63	12	1.75	3.62	21.75	17.25	10.63	12	2.12	5.00	
10	16.00	14.25	12.75	12	1.00	1.19	17.50	15.25	12.75	16	1.12	1.88	20.00	17.00	12.75	16	1.38	2.50	21.50	18.50	12.75	16	1.50	2.75	23.00	19.00	12.75	12	2.00	4.25	26.50	21.25	12.75	12	2.63	6.50	
12	19.00	17.00	15.00	12	1.00	1.25	20.50	17.75	15.00	16	1.25	2.00	22.00	19.25	15.00	20	1.38	2.62	24.00	21.00	15.00	20	1.50	3.12	26.00	22.50	15.00	16	2.12	4.88	30.00	24.25	15.00	12	2.88	7.25	
14	21.00	18.75	16.25	12	1.12	1.38	23.00	20.25	16.25	20	1.25	2.12	23.75	20.75	16.25	20	1.50	2.75	25.25	22.00	16.25	20	1.63	3.38	29.50	25.00	16.25	16	2.38	5.25	-	-	-	-	-	-	
16	23.50	21.25	18.50	16	1.12	1.44	25.50	22.50	18.50	20	1.38	2.25	27.00	23.75	18.50	20	1.63	3.00	27.75	24.25	18.50	20	1.75	3.50	32.50	27.75	18.50	16	2.63	5.75	-	-	-	-	-	-	
18	25.00	22.75	21.00	16	1.25	1.56	28.00	24.75	21.00	24	1.38	2.38	29.25	25.75	21.00	20	1.75	3.25	31.00	27.00	21.00	20	2.00	4.00	36.00	30.50	21.00	16	2.88	6.38	-	-	-	-	-	-	
20	27.50	25.00	23.00	20	1.25	1.69	30.50	27.00	23.00	24	1.38	2.50	32.00	28.50	23.00	24	1.75	3.50	33.75	29.50	23.00	20	2.13	4.25	38.75	32.75	23.00	16	3.12	7.00	-	-	-	-	-	-	
22	29.50	27.25	25.25	20	1.38	1.81	33.00	29.25	25.25	24	1.63	2.63	34.25	30.63	25.25	24	1.75	3.75	-	-	-	-	-	-	-	-	-	-	-	-	-	-	-	-	-	-	
24	32.00	29.50	27.25	20	1.38	1.88	36.00	32.00	27.25	24	1.63	2.75	37.00	33.00	27.25	24	2.00	4.00	41.00	35.50	27.25	20	2.63	5.50	46.00	39.00	27.25	16	3.63	8.00	-	-	-	-	-	-	

NPS	CLASS 150 ANSI B16.5					300 ANSI B16.5					600 ANSI B16.5					900 ANSI B16.5								
	OD OF FLANGE (OD)	DIA. OF BOLT CIRCLE (BC)	DIA. OF RAISED FACE (RF)	NO. OF BOLT HOLES	DIA. OF BOLT HOLE (BH)	BLIND THICKNESS (T)	OD OF FLANGE (OD)	DIA. OF BOLT CIRCLE (BC)	DIA. OF RAISED FACE (RF)	NO. OF BOLT HOLES	DIA. OF BOLT HOLE (BH)	BLIND THICKNESS (T)	OD OF FLANGE (OD)	DIA. OF BOLT CIRCLE (BC)	DIA. OF RAISED FACE (RF)	NO. OF BOLT HOLES	DIA. OF BOLT HOLE (BH)	BLIND THICKNESS (T)	OD OF FLANGE (OD)	DIA. OF BOLT CIRCLE (BC)	DIA. OF RAISED FACE (RF)	NO. OF BOLT HOLES	DIA. OF BOLT HOLE (BH)	BLIND THICKNESS (T)
SERIES A - ANSI 16.47																								
26	34.25	31.75	29.50	24	1.38	2.63	38.25	34.50	29.50	28	1.75	3.25	40.00	36.00	29.50	28	2.00	4.94	42.75	37.50	29.50	20	2.88	6.31
28	36.50	34.00	31.50	28	1.38	2.75	40.75	37.00	31.50	28	1.75	3.50	42.25	38.00	31.50	28	2.12	5.19	46.00	40.25	31.50	20	3.12	6.75
30	38.75	36.00	33.75	28	1.38	2.88	43.00	39.25	33.75	28	1.88	3.69	44.50	40.25	33.75	28	2.12	5.50	48.50	42.75	33.75	20	3.12	7.18
32	41.75	38.50	36.00	28	1.62	3.13	45.25	41.50	36.00	28	2.00	3.88	47.00	42.50	36.00	28	2.38	5.81	51.75	45.50	36.00	20	3.38	7.62
34	43.75	40.50	38.00	32	1.62	3.19	47.50	43.50	38.00	28	2.00	4.07	49.00	44.50	38.00	28	2.38	6.06	55.00	48.25	38.00	20	3.62	8.06
36	46.00	42.75	40.25	32	1.62	3.50	50.00	46.00	40.25	32	2.12	4.32	51.75	47.00	40.25	28	2.62	6.38	57.50	50.75	40.25	20	3.62	8.44
38	48.75	45.25	42.25	32	1.62	3.38	46.00	43.00	40.50	32	1.62	4.19	50.00	45.75	41.50	28	2.38	6.12	57.50	50.75	43.25	20	3.62	8.50
40	50.75	47.25	44.25	36	1.62	3.50	48.75	45.50	42.75	32	1.75	4.44	52.00	47.75	43.75	32	2.38	6.38	59.50	52.75	45.75	24	3.62	8.81
42	53.00	49.50	47.00	36	1.62	3.75	50.75	47.50	44.75	32	1.75	4.63	55.25	50.50	46.00	28	2.62	6.75	61.50	54.75	47.75	24	3.62	9.12
44	55.25	51.75	49.00	40	1.62	3.94	53.25	49.75	47.00	32	1.88	4.82	57.25	52.50	48.25	32	2.62	7.00	64.88	57.62	50.00	24	3.88	9.56
46	57.25	53.75	51.00	40	1.62	4.00	55.75	52.00	49.00	28	2.00	5.00	59.50	54.75	50.25	32	2.62	7.31	68.25	60.50	52.50	24	4.12	10.06
48	59.50	56.00	53.50	44	1.62	4.19	57.75	54.00	51.25	32	2.00	5.19	62.75	57.50	52.50	32	2.62	7.69	70.25	62.50	54.50	24	4.12	10.38
50	61.75	58.25	55.50	44	1.88	4.32	60.25	56.25	53.50	32	2.12	5.44	65.75	60.00	54.50	28	3.12	8.00	-	-	-	-	-	-
52	64.00	60.50	57.50	44	1.88	4.50	62.25	58.25	-	32	2.12	5.63	67.75	62.00	-	32	3.12	8.25	-	-	-	-	-	-
54	66.25	62.75	59.50	44	1.88	4.69	65.25	61.00	-	28	2.38	5.94	70.00	64.25	-	32	3.12	8.56	-	-	-	-	-	-
56	68.75	65.00	62.00	48	1.88	4.82	67.25	63.00	-	28	2.38	6.00	73.00	66.75	-	32	3.38	8.88	-	-	-	-	-	-
58	71.00	67.25	64.00	48	1.88	5.00	69.25	65.00	-	32	2.38	6.19	75.00	68.75	-	32	3.38	9.12	-	-	-	-	-	-
60	73.00	69.25	66.00	52	1.88	5.13	71.25	67.00	-	32	2.38	6.38	78.50	71.75	-	28	3.62	9.56	-	-	-	-	-	-
SERIES B - ANSI 16.47																								
26	30.94	29.31	28.00	36	0.88	1.75	34.12	31.62	29.00	32	1.38	3.50	35.00	31.75	28.62	28	1.75	4.38	40.25	35.50	30.00	20	2.62	6.06