



VLD-2500 VACUUM LEAK DETECTOR OPERATING INSTRUCTIONS



www.USAIindustries.com

(713) 941-3797 • (800) 456-8721

315 State Street • S. Houston, TX 77587



VLD-2500 VACUUM LEAK DETECTOR OPERATING INSTRUCTIONS

1

Seal the far-end of the suspect tube(s) using either a Rubber Tapered tube plug or the "T" Handle tool provided in the VLD Kit, designed for the specific tube O.D. and gauge.

Rubber Tapered Plug



2

On the opposite end of the tube(s) you just plugged, insert the cone-shaped nozzle into the suspect tube(s).

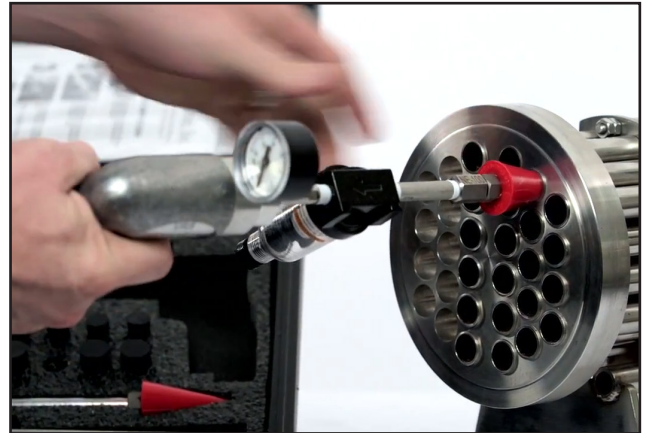

3

Pull the trigger on the VLD-2500 and monitor the gauge at the top of the unit.

90PSIG should read between 15 - 18 inHg when completely sealed. *(The exact reading can be checked by sealing the cone end and reading the inHg before testing the tube)*





VLD-2500 VACUUM LEAK DETECTOR OPERATING INSTRUCTIONS

4

Hold trigger and monitor gauge for approximately 10 seconds.



5

If the tube does not reach the same vacuum, a drop in pressure will be detected on the gauge, indicating a leak in the tube.

Larger leaks will show more quickly than smaller ones.

***NOTE:** The vacuum level will decrease as the air supply pressure drops to the gun. A possible leaking tube detection should have a repeated test to validate. The reading for a sealed cone end of the gun away from the tube should be measured before repeating the tube test. Checks should be made that the seal cone is sealing to the tube and the other tube end is plugged. If the measured tube vacuum (ie ≤ 14 inHg) is still less when compared to sealing the end of the TLD cone (15-18 inHg) on the repeated test, then the tube is leaking.*



NOTE: When testing tubes that have dirt or scale build-up, it may become necessary to replace or clean the filter within the VLD unit.



VLD-2500 VACUUM LEAK DETECTOR PARTS LIST

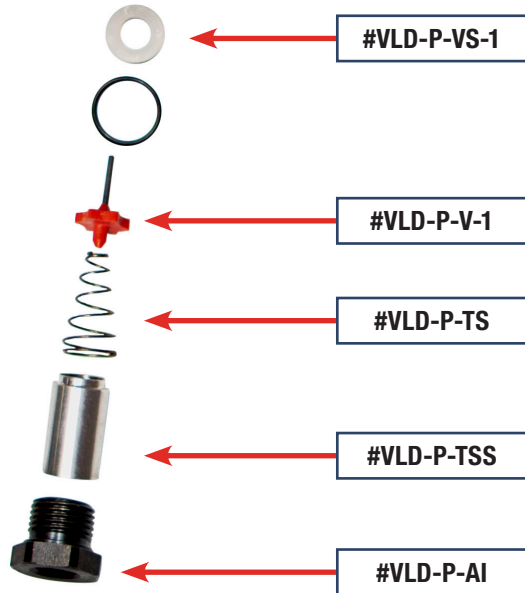
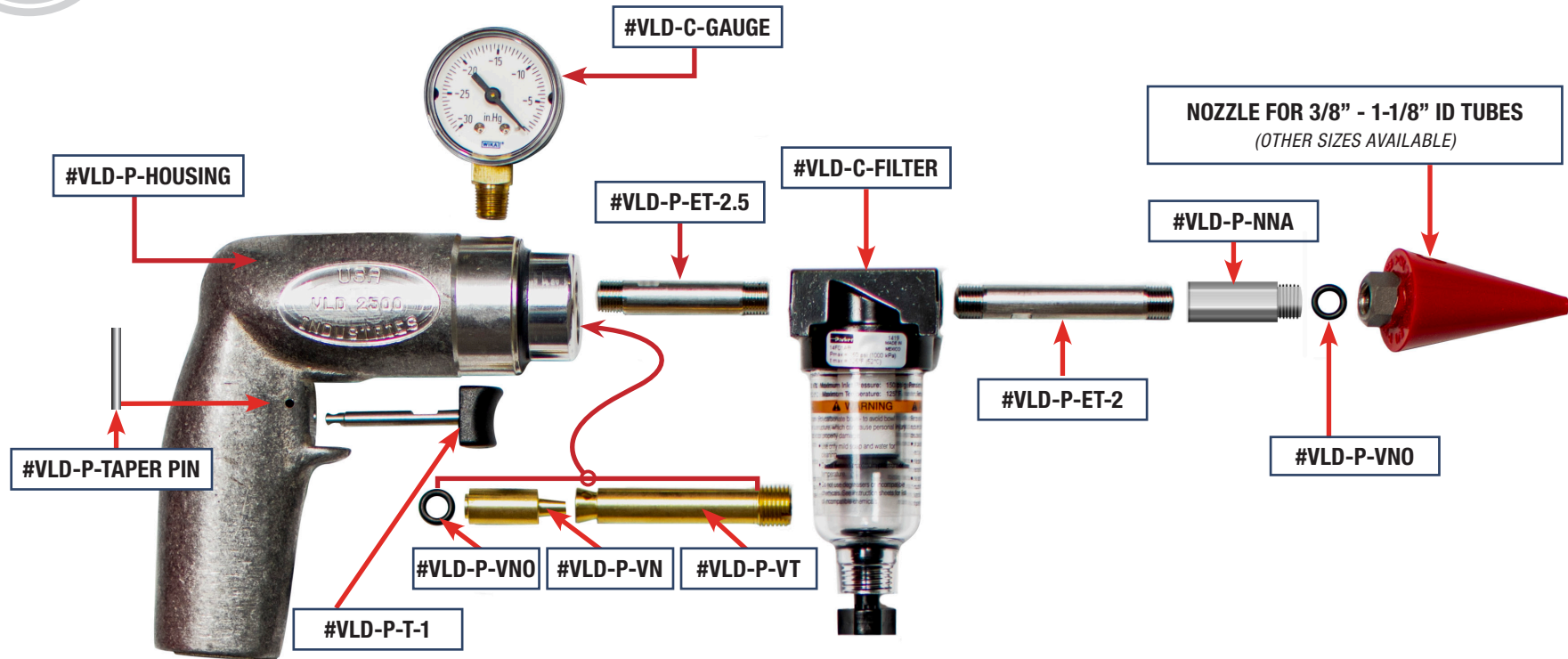

VLD KIT

KIT INCLUDES:
VLD-2500 Detector Gun
2 Nozzles
"T"-Handle
Rubber Plugs
Carrying Case

